



# Outline Landscape Proposals for New Pitches Stepney Green, London, E1

754.01(RP)002 Landscape Report  
ON BEHALF OF LONDON BOROUGH OF TOWER HAMLETS

02/09/2019

## DRAFT



Robert Myers Associates  
LANDSCAPE ARCHITECTURE

# Contents

1. PURPOSE OF REPORT	03
2. LAYOUT OPTIONS - OPPORTUNITIES & CONSIDERATIONS	04
3. LAYOUT OPTIONS - LANDSCAPE PROPOSALS	05
4. PREFERRED OPTION	10



# 01 Stepney Green

## PURPOSE OF THE REPORT

The brief called for analysis of two layouts: options 1 and 2.

The purpose of the report is to:

- Review both pitch layout options and provide comment on the opportunities and considerations of each within the site;
- Provide landscape proposals suggesting mitigation;
- Choose the option with the least impact and the most opportunities for the park on the park and adjacent play area.

This is based on the diagrams in the client brief)

OPTION 1



OPTION 2

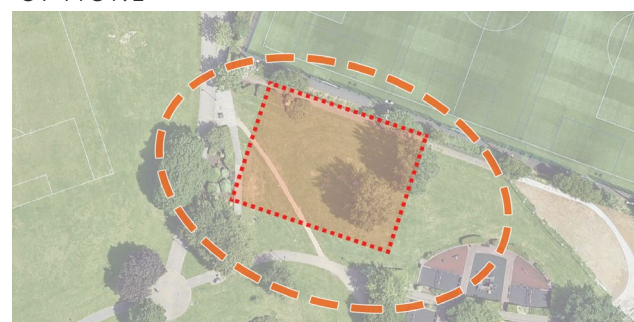

## SITE AERIAL PLAN



NTS @ A3

KEY:



Zone considered for the football pitches



Main pedestrian route



Informal pathway link



Pedestrian route



Main entrances to the site



Main road



Secondary pedestrian route



Path to retain



Key areas



Entrance to the play area

This drawing is based on outline CADsurvey information provided by Edina (27.08.2019)



Robert Myers Associates



# 02 Stepney Green

## LAYOUT OPTION 1 - OPPORTUNITIES & CONSIDERATIONS

### Key opportunities and considerations:

-  Existing mound: opportunity to remodel/ remove;
-  Key nodes in circulation: retain/ strengthen;
-  Busy movement axis: retain/ enhance;
-  Existing buffer (low hedge);
-  Existing noise buffer: this is currently provided by the mound;
-  Elevated views; retained where possible;
-  Long views; retain
-  Existing green screen benefits both the pitch and the park. Retain with localised openings to allow new gates into new pitches;
-  Pinch point between existing playground and proposed zone for new pitches



This drawing is based on outline CADsurvey information provided by Edina (27.08.2019)

LAYOUT OPTION 1 - OPPORTUNITIES & CONSIDERATIONS

North  
NTS @ A3



Robert Myers Associates

Stepney Green. Landscape Report rev DRAFT



# 02 Stepney Green

## LAYOUT OPTION 2 - OPPORTUNITIES & CONSIDERATIONS

### Key opportunities and considerations:

-  Existing mound: opportunity to remodel/ remove;
-  Key nodes in circulation: retain/ strengthen;
-  Busy movement axis: retain/ enhance;
-  Existing buffer (low hedge);
-  Existing noise buffer: this is currently provided by the mound;
-  Elevated views; retain where possible
-  Long views; retain;
-  Existing green screen benefits both the pitch and the park. Retain with localised openings to allow new gates into new pitches;
-  Pinch point: existing playground + proposed zone for new pitches



This drawing is based on outline CADsurvey information provided by Edina (27.08.2019)

LAYOUT OPTION 2 - OPPORTUNITIES & CONSIDERATIONS *North*  
NTS @ A3



# 03 Stepney Green

## LAYOUT OPTION 1 - LANDSCAPE PROPOSALS



## LAYOUT OPTION 1 - LANDSCAPE PROPOSALS

This drawing is based on outline CADsurvey information provided by Edina (27.08.2019)



Robert Myers Associates



# 03 Stepney Green

## LAYOUT OPTION 1 - LANDSCAPE PROPOSALS

### Design principles shown in the sections:

- The removal of existing mound and trees to create level area for pitches;
- Small planted buffers to separate views between playground and pitches;
- Potential for minimal mounding where space allows;
- Potential for seating with views of the sports activities, but away from the playground.

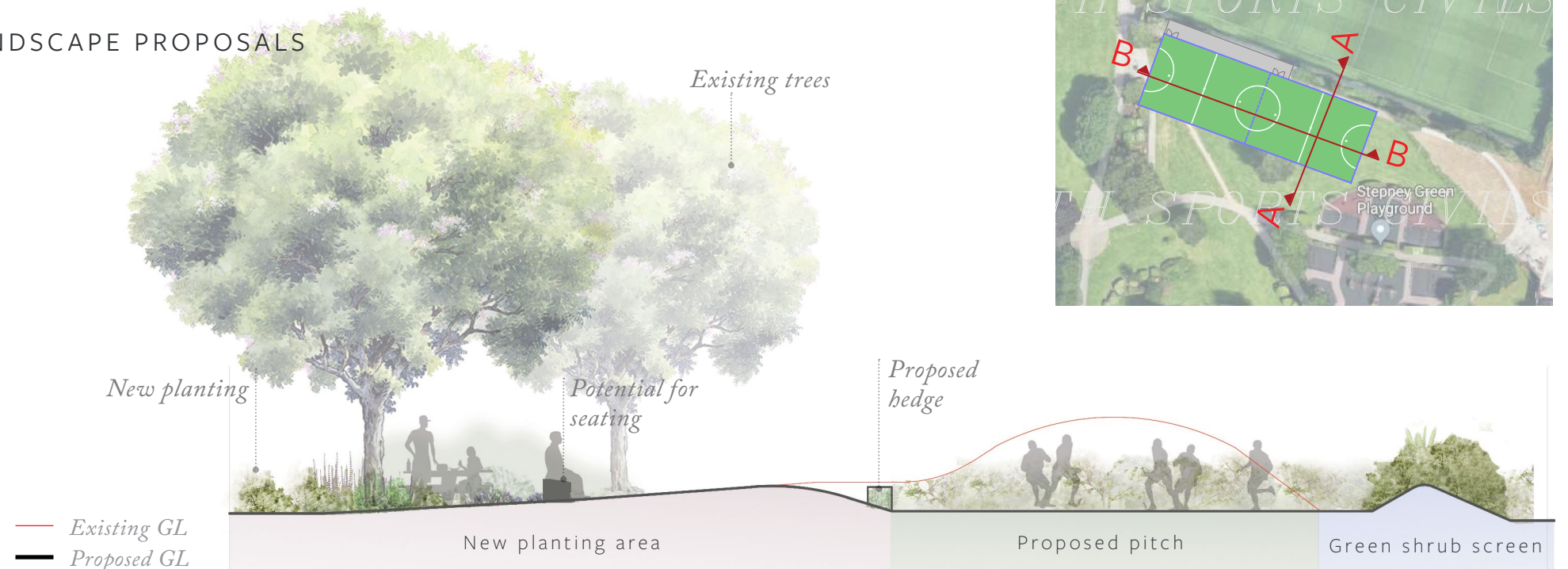

OPTION1- LANDSCAPE PROPOSALS SECTION A-A

Scale 1:250 @ A3



OPTION1- LANDSCAPE PROPOSALS SECTION B-B

Scale 1:250 @ A3





# 04 Stepney Green

## LAYOUT OPTION 2 - LANDSCAPE PROPOSALS



## LAYOUT OPTION 2 - LANDSCAPE PROPOSALS

This drawing is based on outline CADsurvey information provided by Edina (27.08.2019)



Scale 1:500 @ A3



Robert Myers Associates

Stepney Green. Landscape Report rev DRAFT



# 04 Stepney Green

## LAYOUT OPTION 2 - LANDSCAPE PROPOSALS

### Principles of the proposed sections:

- Removal of existing mounding trees to create space for new pitches
- Much more space available to create .. noise buffer for playground
- More space for planting between sport and play.
- mounding also offers potential for views of sport where this is appropriate
- Realignment of footpath

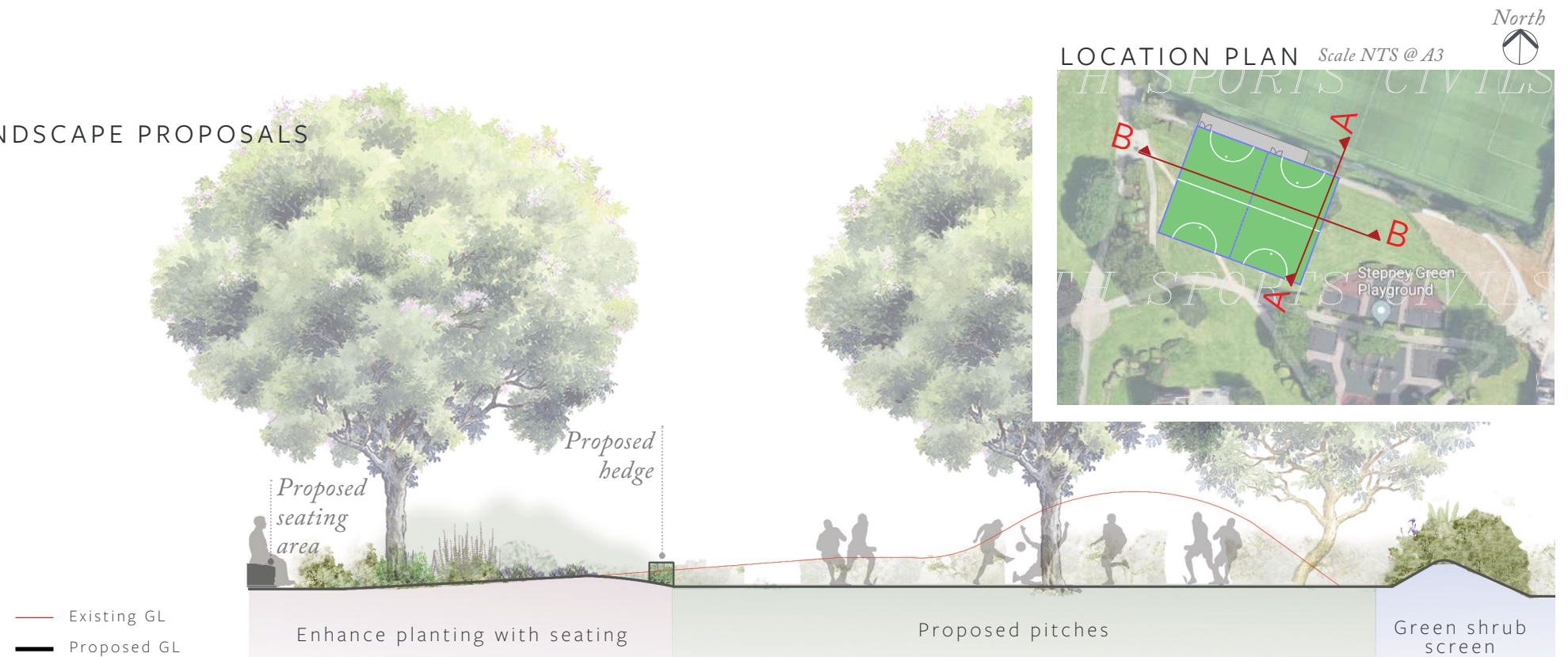

OPTION2- LANDSCAPE PROPOSALS SECTION A-A



OPTION2- LANDSCAPE PROPOSALS SECTION B-B  
Scale 1:250 @ A3





# 05 Stepney Green

PREFERRED OPTION: OPTION 2

After considering all analysis carried out on site it results that the best landscape proposal with the least impact on the park and adjacent park is the Option 2 for the following reasons:

1. Location of the sport pitch in option B allows more space between the playground and the proposed adjacent sport area.
2. More space for the creation of a green buffer;
3. Opportunity to create mounding that emphasise the separation between the sport area and the palyground
4. Opportunity to watch the football math from the highest point;
5. Potential noise generated by the football use limitedated by mounding
6. More welcoming and spacious entrance square, that leave more space free from any vegetation distruption;
7. More space for pic nic
8. Space to relocate the informal pathway with a more softnen and naturalistic design.



This drawing is based on outline CADsurvey information provided by Edina (27.08.2019)

PREFERRED LAYOUT OPTION WITH LANDSCAPE PROPOSALS *North*

Scale 1:500 @ A3







# Robert Myers Associates

LANDSCAPE ARCHITECTURE

13-15 COVENT GARDEN  
CAMBRIDGE  
CB1 2HS

T: +44 (0) 1223 351400

PENSONS YARD  
STOKE BLISS  
TENBURY WELLS

WR15 8RT  
T: +44 (0) 1885 227377

[info@robertmyers-associates.co.uk](mailto:info@robertmyers-associates.co.uk)  
[www.robertmyers-associates.co.uk](http://www.robertmyers-associates.co.uk)